

Recycling mineral wool

The Hansek Maschinenbau company has extensive experience when it comes to recycling rock and glass wool. We provide machines for the following areas:

- Edge trim shredding
- Waste shredding for sheets and rolls
- Filter systems for line dedusting

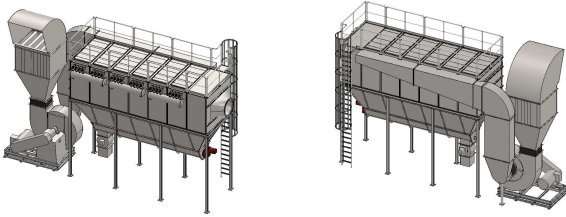

- Chain conveyors, screw conveyors and screw presses for process water purification
- Recycling systems for treating waste material and metered feedback into the product

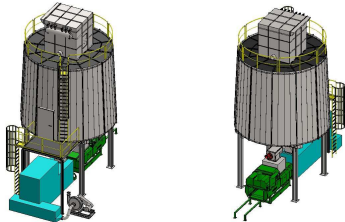

If you have any questions, please contact us at any time and we can develop a suitable offer for you.

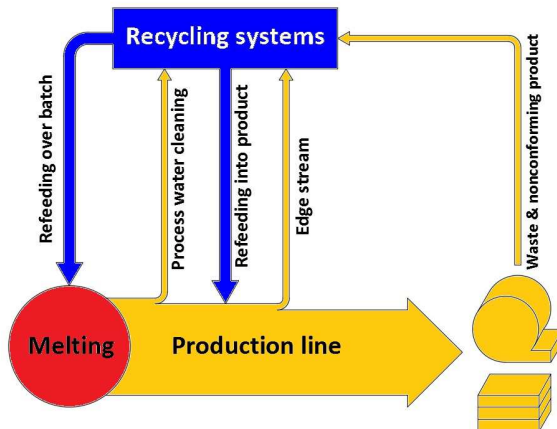

Contract manufacture

In contract manufacture, our experienced special purpose machinery manufacture employees are at your disposal. On request, we can produce entire machines and modules in accordance with your drawings.

We are also happy to take on design and development tasks in AutoCAD 2D and SolidWorks 3D.

Our certified welders have all the required welding certificates.

HANSEK

MASCHINENBAU

Hansek Maschinenbau GmbH
Daruper Straße 2-4
48727 Billerbeck
Germany

Phone: +49 (0) 2543 – 930 890 0
Fax: +49 (0) 2543 – 930 890 2

Mail: info@hansek.de
Web: www.hansek.de

Screw presses

Disc mills

Spiral crushers

Recycling mineral wool

Construction- & Development requests

Contract manufacture

About us

Hansek Maschinenbau GmbH is a medium-sized family company based in Münsterland. Our customers benefit from the high quality and reliability of our solutions as well as our years of experience in machinery and plant engineering

We plan, produce and assemble machines and plants for the drainage and shredding of a wide range of materials. We are also your expert partner in all areas of special purpose machinery manufacture.

We provide you with individual planning, design engineering in AutoCAD 2D and SolidWorks 3D, production, assembly, commissioning, documentation, spare parts service, maintenance, repairs, dismantling and disposal.

If you have any questions, please contact us in person, by phone or via e-mail.



Head office in Billerbeck - Germany

Screw press HPS-300

The screw press HPS-300 can be used to drain paper, cardboard, waste materials, mineral wool, rock wool, glass wool, screenings, wooden fibres and biomass, among other things.

Depending on the material, the screw press achieves a residual moisture of up to 10% with a throughput rate of approx. 500 - 1000 kg/h.

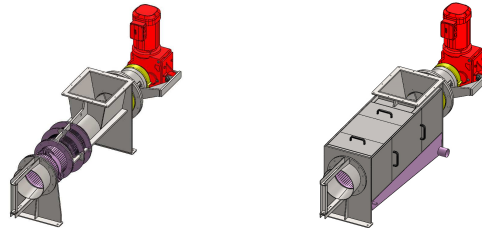

The machine is available in an open or a fully enclosed version.

Spiral crusher HWB-600

The spiral crusher is suited in particular to the shredding of materials such as sheets of rock and glass wool with and without glass fleece, glass fibres as continuous fibres or glass fibre reels.

Depending on the material and the desired finished material, the spiral crusher achieves a throughput rate of over 1500 kg/h.

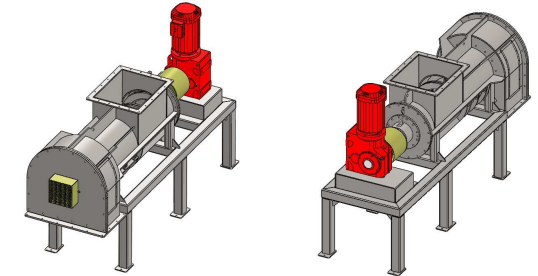

The spiral crusher is also available with a side feed mechanism for sheet material.

Disc mill HSM-300

The disc mill HSM-300 can be used to grind mineral wool, rock wool, glass wool, glass fibres and glass, among other things.

Depending on the material and the grain size set, the disc mill achieves a throughput rate of over 500 kg/h. The dual machine achieves over 1000 kg/h.

The structure of the finished material can be influenced by different discs.

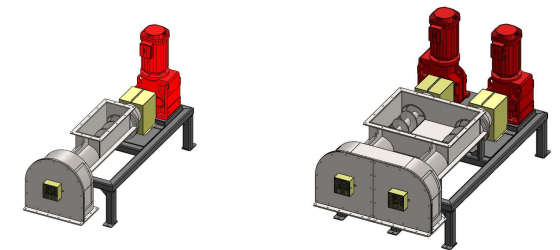

The disc mill is available as a single or dual machine.

All our machines impress with a high processing standard quality. The wear-resistant design guarantees a long service life in continuous operation.

We would be happy to carry out a test with your material in our plant so that you can see the capacity of our machines for yourself.